

# Kaiser Permanente San Diego Medical Center



Kaiser Permanente's new state-of-the-art Medical Center will provide affordable, high-quality health care to residents in San Diego County.

## General Facts:

- Size: 617,215 square feet
- Hospital capacity: 461 beds (321 Phase 1)
- Emergency Department: 39 beds
- Location: 9455 Clairemont Mesa Boulevard
- Opening April 25, 2017

## Administration:

- Jane Finley  
Senior Vice President and Area Manager
- Michael Lalich, MD  
Area Medical Director and Chief of Staff
- Jim Malone  
Chief Administrative Officer

## Services:

- Medical Specialties
- Surgical Specialties
- Emergency Department
- Maternal Child Health Services
- Intensive Care Unit
- Interventional Radiology
- Neonatal Intensive Care Unit

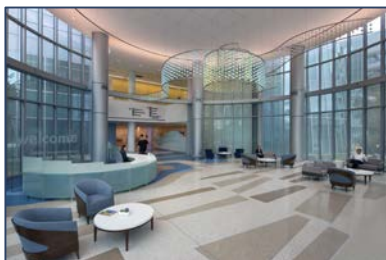

## Green Features:

- SDMC is LEED Platinum™ -- **one of only four health care facilities in the world with this certification**
- Energy-efficient electrical, air, and plumbing
- Use of reclaimed water for landscaping and cooling towers
- 100% LED lighting throughout
- Active chilled beams in patient rooms for energy savings

## Interesting Facility Facts:

- More than 1,900 jobs created: 1,000 hospital jobs, 900+ construction jobs in the facility
- 2.8 million pounds of reinforcing steel
- 1,800,000 glass bottles used
- 32,500,000 aluminum cans used

## Technology:

- One of the most technologically advanced medical centers in the world
- Robotic and image guided surgical equipment
- Patient remote-controlled room environment: blinds, lights, temperature
- Interactive GetWell Network care wall
- Touch screen digital signs
- Kaiser Permanente HealthConnect®: world's largest private electronic health record system